

UTM GRID AND 1969 MAGNETIC NORTH DECLINATION

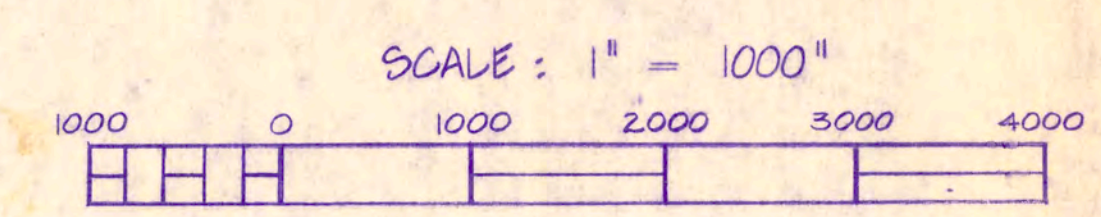

LEGEND

- ZONE BOUNDARIES
- TOPOGRAPHIC CONTOURS
- AERIAL CONTOURS
- SECTION LINES
- MEDIUM DUTY ROAD
- LIGHT-DUTY ROAD
- UNIMPROVED DIRT ROAD
- STATE ROUTE
- RELOCATED ZIO

NOTES

1. TOPOGRAPHIC CONTOUR INTERVALS ARE 10 FEET. DATUM IS MEAN SEA LEVEL ELEVATION. TOPOGRAPHY BY PHOTOGRAMMETRIC METHODS FROM AERIAL PHOTOGRAPHS TAKEN 1966. FIELD CHECKED 1969. 1977 NORTH AMERICAN DATUM.
2. THE AERIAL CONTOURS ILLUSTRATE THE HEIGHT LIMITATIONS WITHIN EACH ZONE.
3. A SLOPE, SUCH AS 40:1, EXPRESSES THE HORIZONTAL DISTANCE OF 40 FEET TO THE VERTICAL OF 1 FOOT.
4. EXISTING TOPOGRAPHICAL SYMBOLS ARE THOSE USED BY U.S. GEOGRAPHICAL SURVEY.
5. IN THOSE AREA WHERE EXISTING TERRAIN OR TREES PENETRATE ONE OR MORE OF THE IMAGINARY SURFACES, THE HEIGHT OF THE STRUCTURES SHALL BE RESTRICTED ONLY TO THE HEIGHT OF THE CANOPY WHICH PROVIDES A NATURAL SHIELD TO THE STRUCTURES
6. ELEVATIONS OF HIGHEST POINT OR RUNWAY IS 1456.5. SEE SECTION A-A.

HENNING AIRPORT ZONING PLAN

HENNING, MINNESOTA

HENNING - OTTERTAIL COUNTY AIRPORT ZONING BOARD

APPROVAL	<i>W. A. Bell</i>	11/9/76
APPROVAL	<i>Frank R. Stewart</i>	11/9/1976
APPROVAL	<i>A. S. Peters, Mayor</i>	11/9/1976
APPROVAL		DATE
APPROVAL		DATE

REVISIONS		
NO.	DESCRIPTION	DATE
	RELOCATE STATE T.H. ZIO	OCT. 19, 76

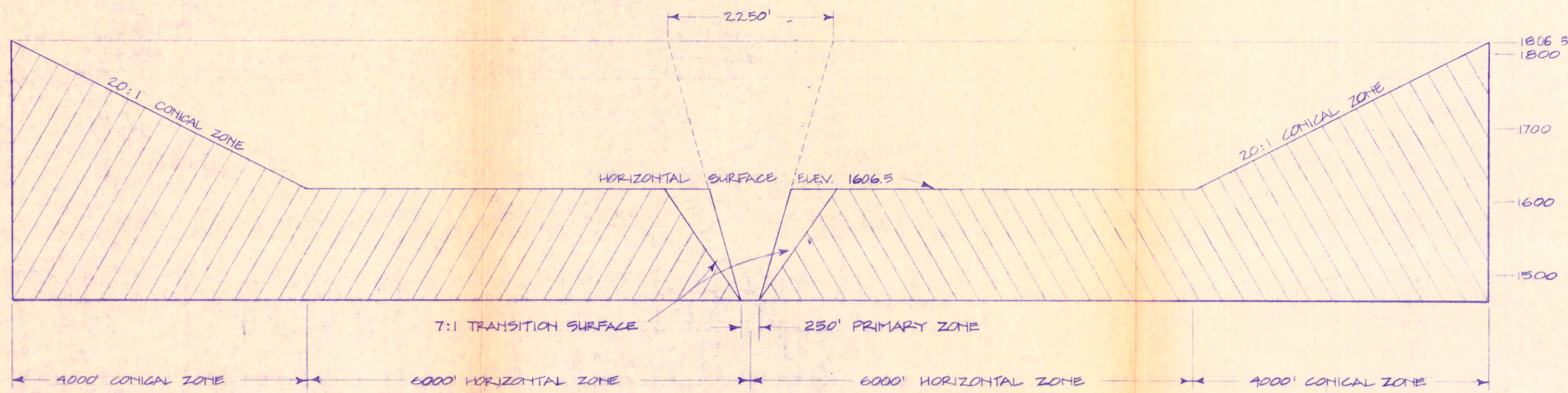

SECTION B-B

SCALE: HOR. 1" = 1000'
VER. 1" = 100'

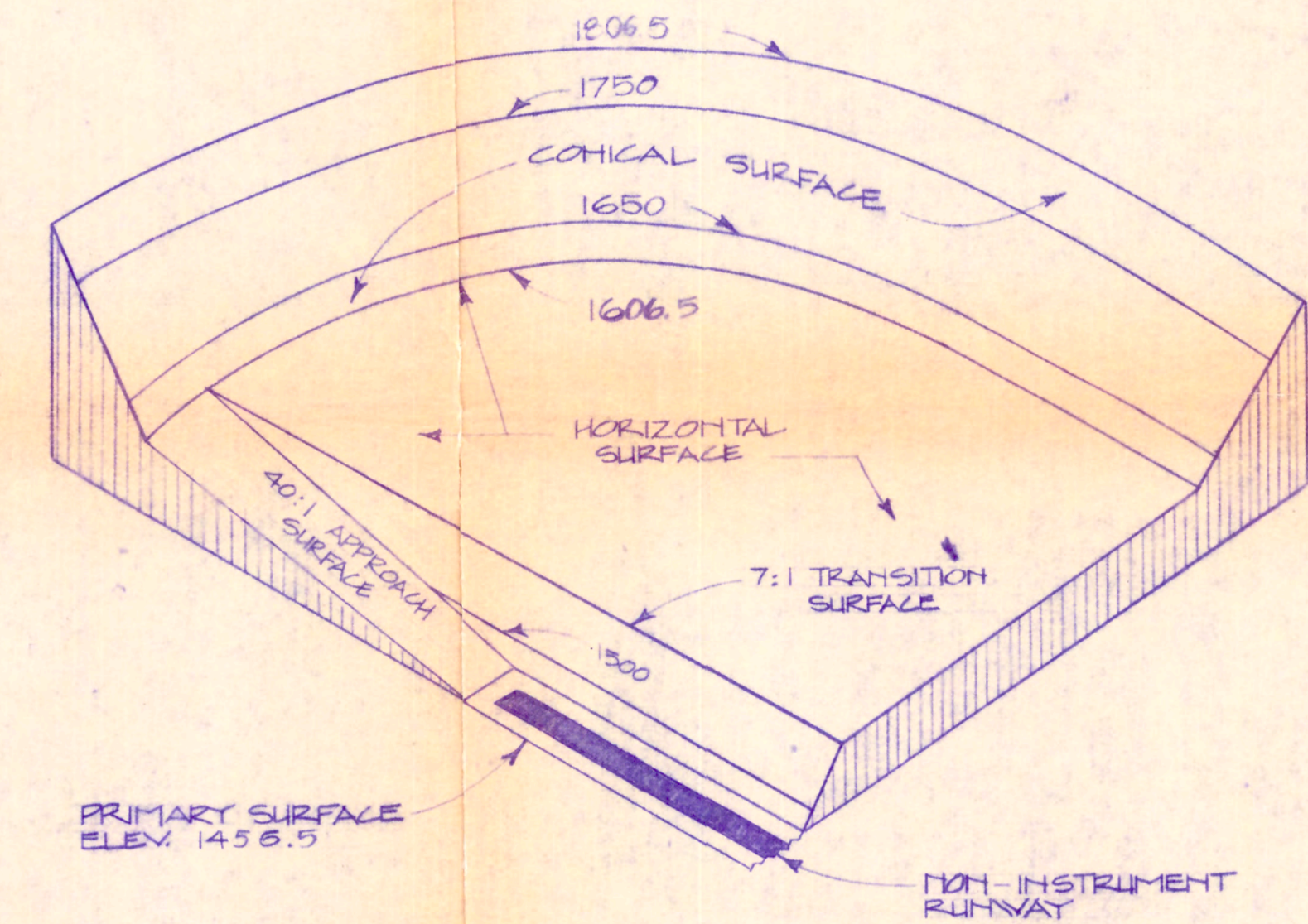

PERSPECTIVE VIEW SHOWING
IMAGINARY SURFACES
NO SCALE

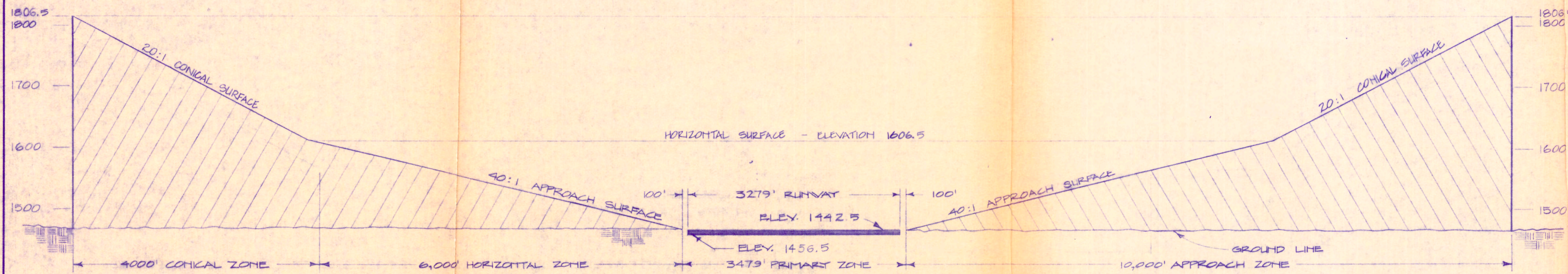

SECTION A-A

SCALE: HOR. 1" = 1000'
VER. 1" = 100'

HENNING MUNICIPAL AIRPORT ZONING

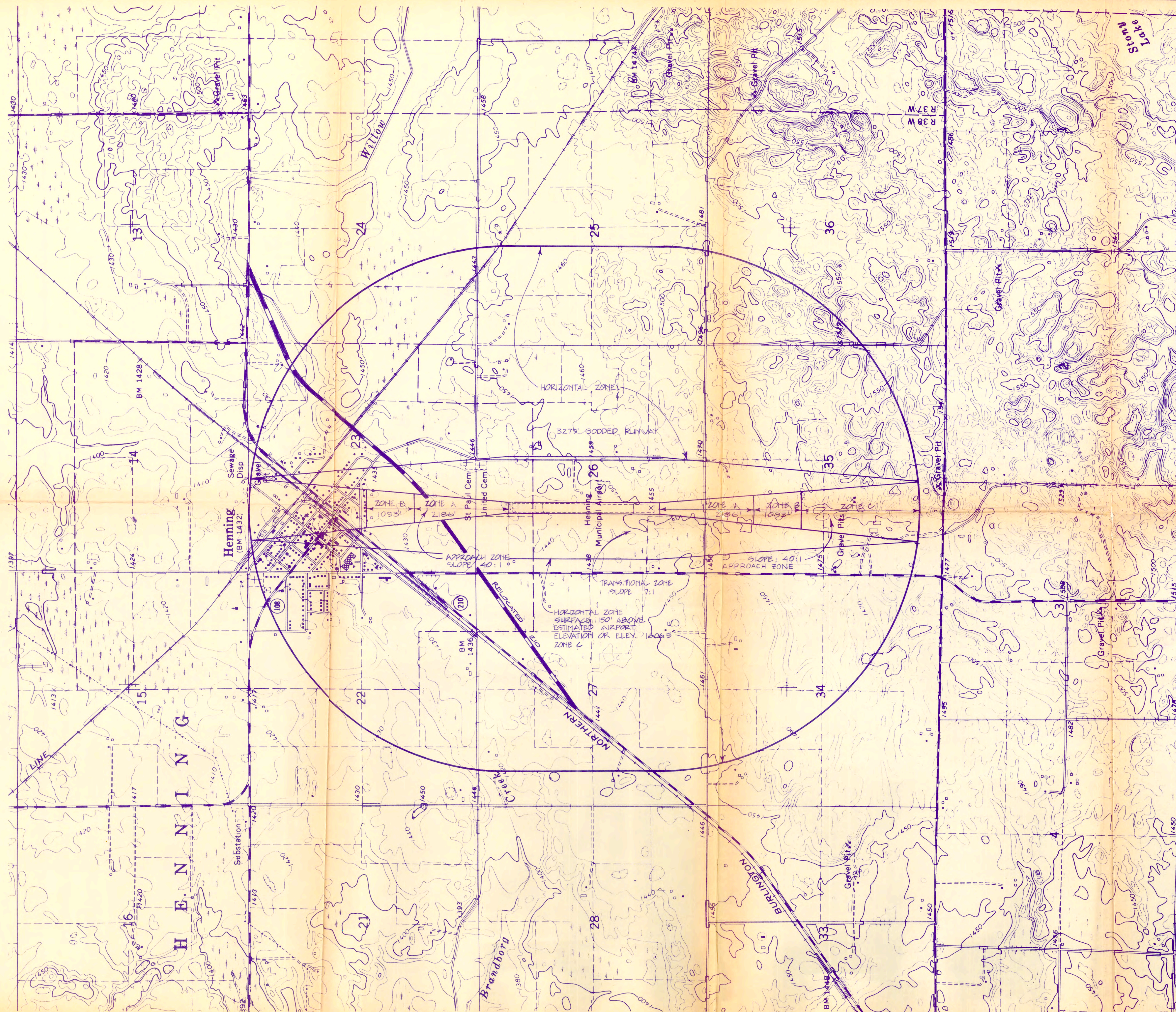

UTM GRID AND 1969 MAGNETIC NORTH DECLINATION

SCALE: 1" = 1000'

LEGEND

- ZONE BOUNDARY
- TOPOGRAPHIC CONTOURS
- AERIAL CONTOURS
- SECTION LINES
- MEDIUM DUTY ROAD
- LIGHT DUTY ROAD
- UNIMPROVED DIRT ROAD
- STATE ROUTE
- RELOCATED RD

NOTES

RELOCATE HIGHWAY 210 1700 FEET FROM NORTH END OF PRIMARY ZONE TO ROAD.
 CLEARANCE TO HORIZONTAL APPROACH ZONE IS 42.5 FEET. 15 FEET IS NORMALLY NEEDED.

NOTES

1. TOPOGRAPHIC CONTOUR INTERVALS ARE 10 FEET. DATUM IS MEAN SEA LEVEL ELEVATION. TOPOGRAPHY BY PHOTOGRAMMETRIC METHODS FROM AERIAL PHOTOGRAPHS TAKEN 1966. FIELD CHECKED 1969. 1927 NORTH AMERICAN DATUM.
2. EXISTING TOPOGRAPHICAL SYMBOLS ARE THOSE USED BY THE U.S. GEOLOGICAL SURVEY.

HENNING MUNICIPAL AIRPORT ZONING

SHEET 3 OF 3